

Heavy Metal Tour 2025

Scotland – Scapa Flow - Stromness

Organisation: Alain Margrève - Sub Aqua Club Wiltz



31.08.2025

07.09.2025

Plan

- ◇ Scapa Flow?
- ◇ What to expect?
- ◇ Who may dive?
- ◇ Accomodation
- ◇ Transfer / Expedition
- ◇ Price

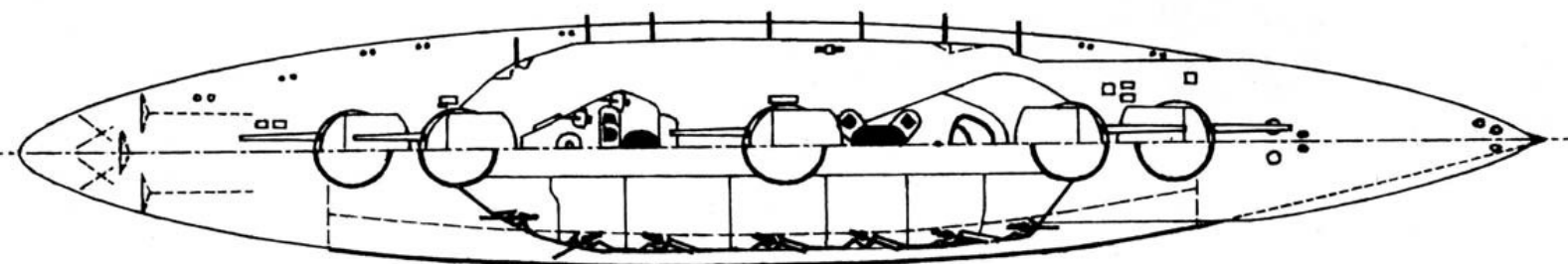
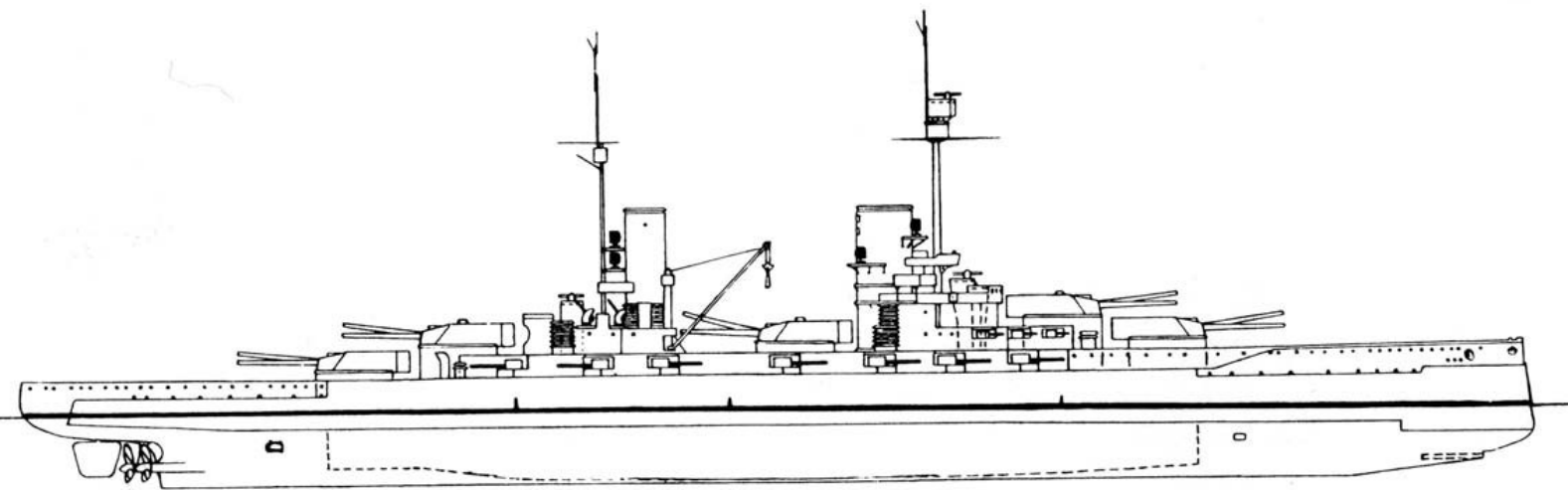

Scapa Flow?



Scapa Flow ?

UK

Scotland

Orkney Islands

Natural harbour between Mainland and Hoy





Why diving in Scapa Flow?

Scapa Flow is the top diving destination of the northern hemisphere and home to the scuttled German High Seas Fleet.

On the 21st June 1919 more than 70 ships, almost the entire German Navy, were scuttled under the orders of Admiral von Reuter.

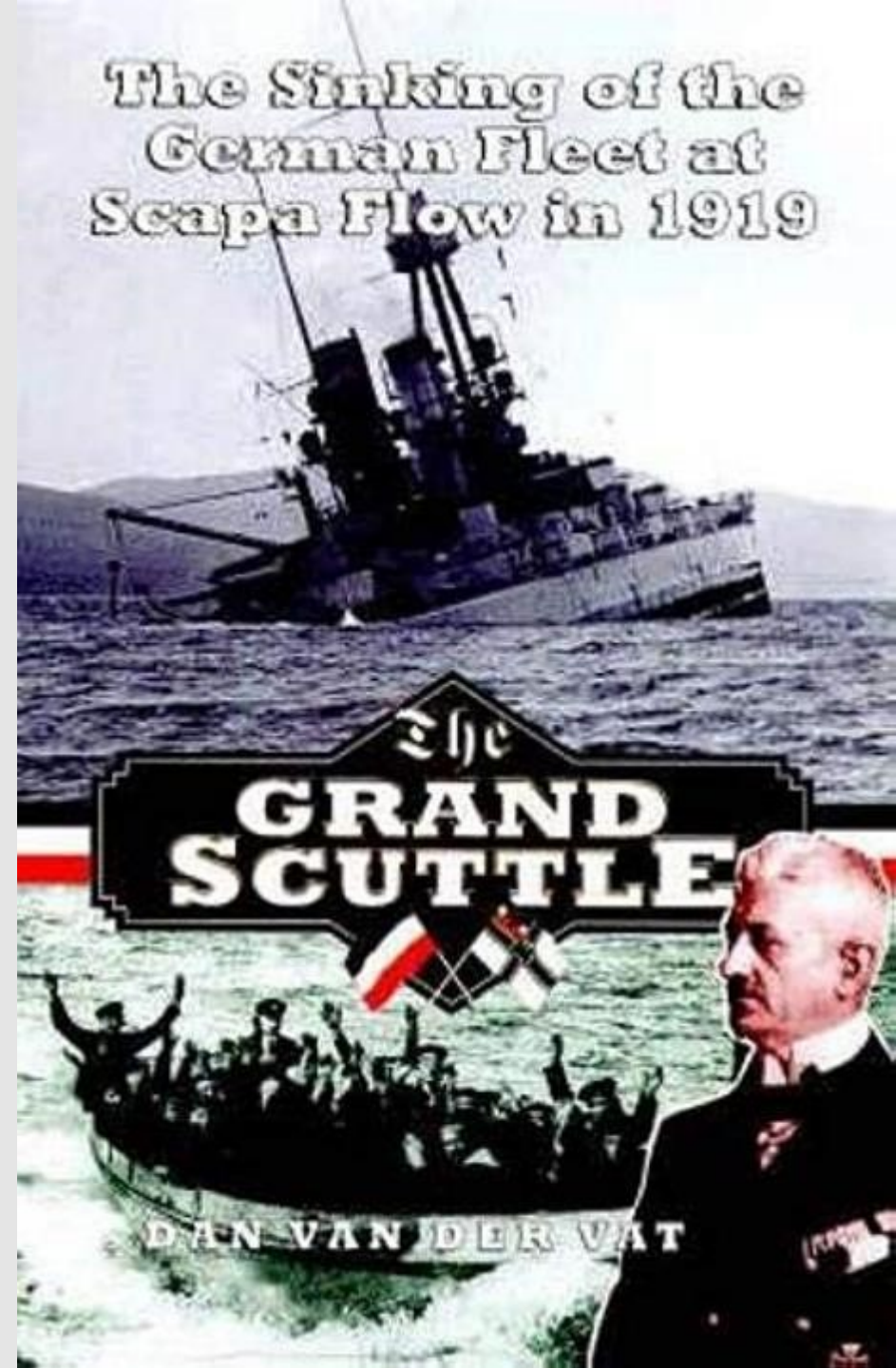

Today 7 wrecks remain between 25-45m on the ground of the sea

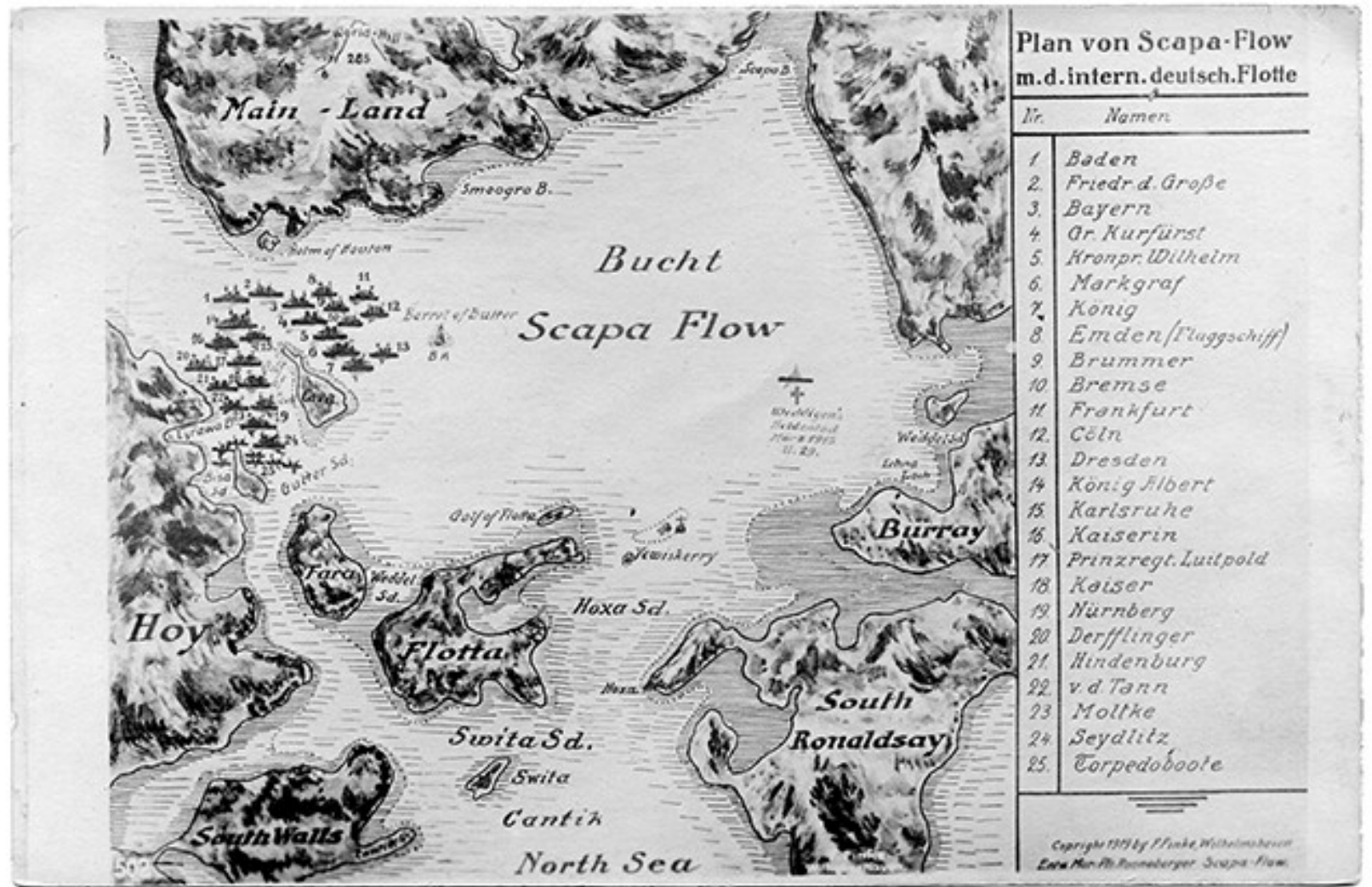

SMS Markgraf
Depth 22-43m
König Class
Battleship

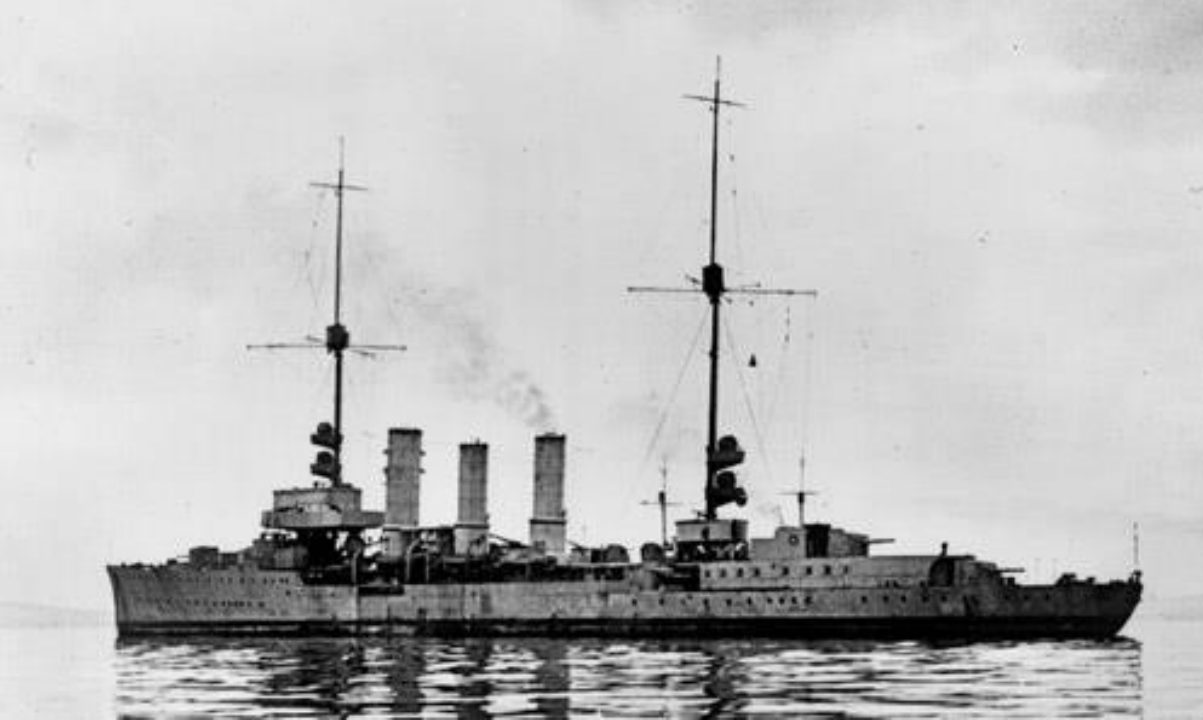

SMS Köln
Depth 36 m
Steamship
Light cruiser

SMS Dresden
Depth 38 m
sistership of
SMS Cöln



SMS Kronprinz Wilhelm
Depth 38 m
battleship

Blockship
&
More wrecks
World War

UB116
depth 27m

UP297
depth 67m



HMS Royal Oak (833 casualties)
War grave

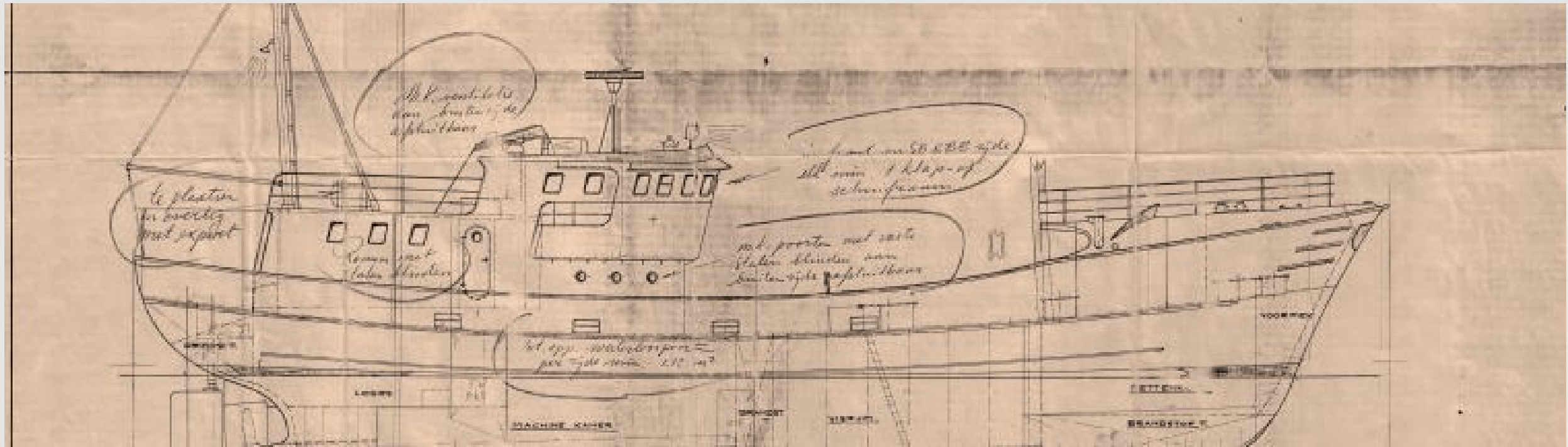

What to expect?



Stromness
1800 habitants

Start + Arrival Port

Welcome to
STROMNESS

“Stromness, Hamnavoe -
'haven inside the bay'
Twenty stone piers, with boats.
A street uncoiling like a sailor's rope.”
George Mackay Brown

Typical dive day:

08.00 Departure
Port Stromness

09.30 1 Dive

12.00 Lunch

14.00 2 Dive

17.00 Arrival
Port Stromness



Facilities in Stromness

Decompression Chamber

2 Pubs

1 Hotel

2 supermarkets, several shops, 2 diveshops

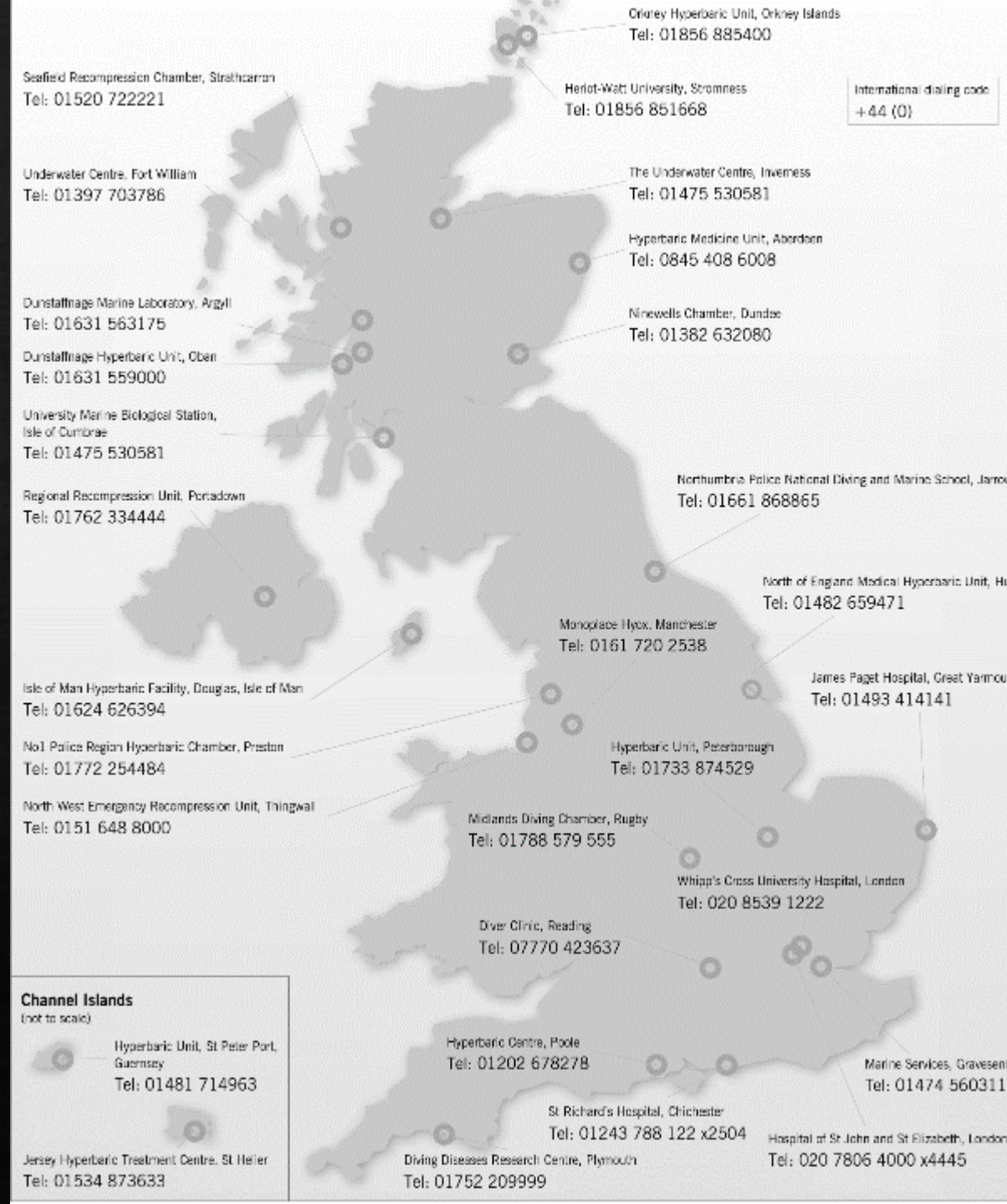



Who may dive?

typical scapa dives

30-45 m

reduced visibility

decompression dives

wreck dives / ltd penetration

water temperature 8 - 14 °C

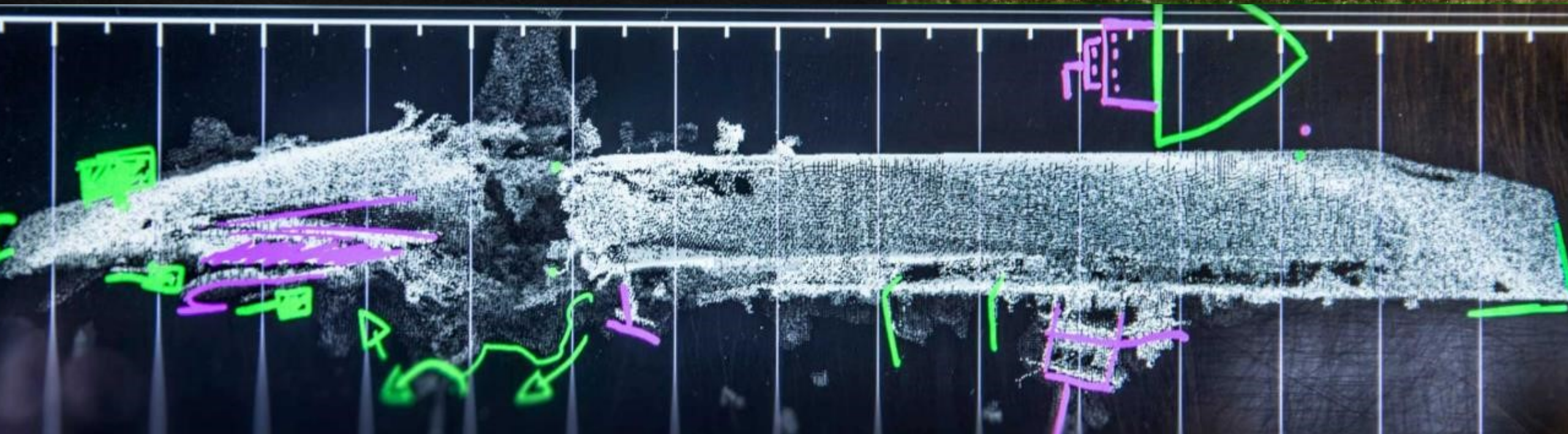

Wreck Dive

40m

Runtime 40

TTS 45 min

Deco EAN 80

without EAN

TTS 91min





Booking conditions:

mind CMAS ** or AOWD + Deep Diver

+

Advanced Nitrox

DIR Configuration + SMB (1.6m) + Reel (min. 45m)

Dry Suit Diver**

experience of minimum 100 Dives

10 training dives with SACW in 2023/24 prior to booking

season 2025: join team preparation and training dives: 10-15 dives

* depth limit CMAS **/AOWD 40m, CMAS***: 56m

** Dry suit certification recommended



Accomodation

Several possibilities for diving (MV Motor Vessel)

MV Valhalla



- ◆ Arrive Saturday
- ◆ Dive Su -Fr
- ◆ 6 days diving, 7 nights liveaboard (breakfast)
- ◆ 12 divers (full charter = 11 divers pay)
- ◆ Price: +/- 1021 Euro





Transfer / Expedition

Distance 1666km

2 x ferry / Eurotunnel
2 x airport transfer
(London/Edinburgh/Kirkwall)

Challenge:
12 Divers

Bi / CCR / Stage / Drysuit
/ Regulators / Clothing

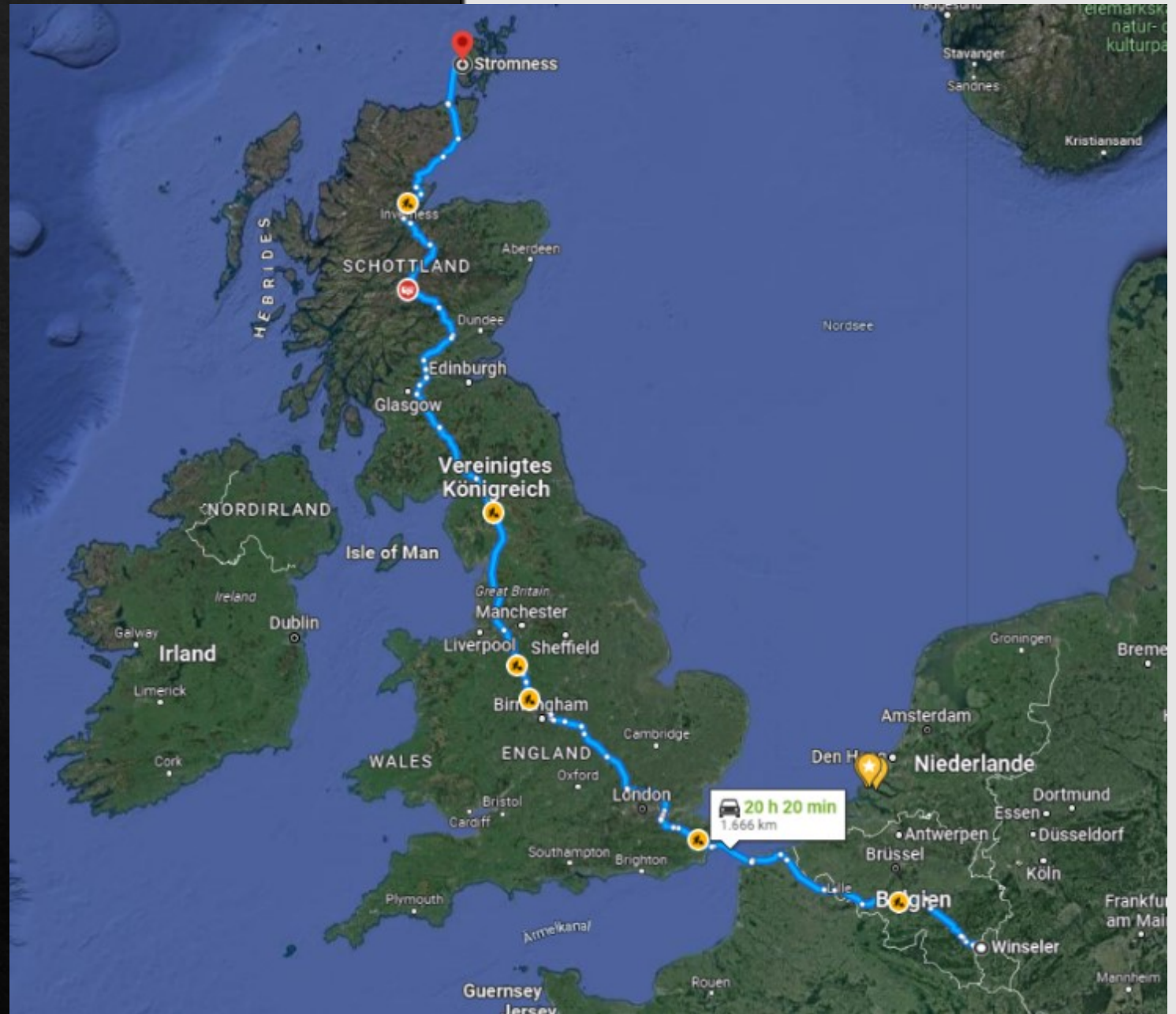

Roadtrip from Luxembourg to Stromness primary plan

Hinflug: Samstag, 09. September 2023 Abreissdaten		
Amsterdam (AMS), Niederlande		
Abflug Sa. 09. Sep. 08:00 Uhr	Ankunft Sa. 09. Sep. 08:25 Uhr	Klm Royal Dutch Airlines (KL 1277) Flugzeugtyp - Boeing 737-600 (winqkts) Klasse: Economy Freigeäck: Handgepäck inkl.
Internationale Flughafen Amsterda... (AMS) Amsterdam, Niederlande	Flughafen Turnhouse (EDI) Edinburgh, Großbritannien	
Umschlagsverbindung Wechsel des Flugzeugs Sa. 09. Sep. 08:25 - 12:40 Stoppzeit: 4:15		
Edinburgh (EDI), Großbritannien		
Abflug Sa. 09. Sep. 12:40 Uhr	Ankunft Sa. 09. Sep. 13:55 Uhr	Loganair (LM 331) Flugzeugtyp - Aerospatiale/Airbus ATR 42/ ATR 72 Klasse: Economy Freigeäck: Handgepäck inkl.
Flughafen Turnhouse (EDI) Edinburgh, Großbritannien	Flughafen (KCI) Kirkwall, Großbritannien	
Rückflug: Samstag, 16. September 2023		
Kirkwall (KCI), Großbritannien		
Abflug Sa. 16. Sep. 07:30 Uhr	Ankunft Sa. 16. Sep. 08:20 Uhr	Loganair (LM 31) Flugzeugtyp - Aerospatiale/Airbus ATR 42/ ATR 72 Klasse: Economy Freigeäck: Handgepäck inkl.
Flughafen (KCI) Kirkwall, Großbritannien	Flughafen Dyce (ABZ) Aberdeen, Großbritannien	
Umschlagsverbindung Wechsel des Flugzeugs Sa. 16. Sep. 08:20 - 12:35 Stoppzeit: 4:15		
Aberdeen (ABZ), Großbritannien		
Abflug Sa. 16. Sep. 12:35 Uhr	Ankunft Sa. 16. Sep. 15:10 Uhr	Klm Royal Dutch Airlines (KL 1446) Flugzeugtyp - Embraer 190 Klasse: Economy Freigeäck: Handgepäck inkl.
Flughafen Dyce (ABZ) Aberdeen, Großbritannien	Internationale Flughafen Amsterda... (AMS) Amsterdam, Niederlande	



Amsterdam – Edinburgh (KLM)
Edinburgh – Kirkwall (Loganair)

Kirkwall – Aberdeen (Loganair)
Aberdeen – Amsterdam (KLM)

KLM: 23kg, Handgepäck + Tauchgepäck
Loganair: maximal Gewicht 25kg pro Valiss, Maximal 30kg +
50Euro (Tauchgepäck)

Price: ca 550 Euro +
local transfer to be organized + parking fees

Roadtrip from Luxembourg to Stromness primary plan



Lux – Amsterdam

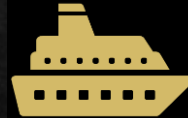

Amsterdam – Newcastle



Newcastle – Scrabster



Scrabster - Stromness

Price: ca 340 Euro / Persoun
+ evtl location camionette / Sprit

Roadtrip from Luxembourg to Stromness primary plan

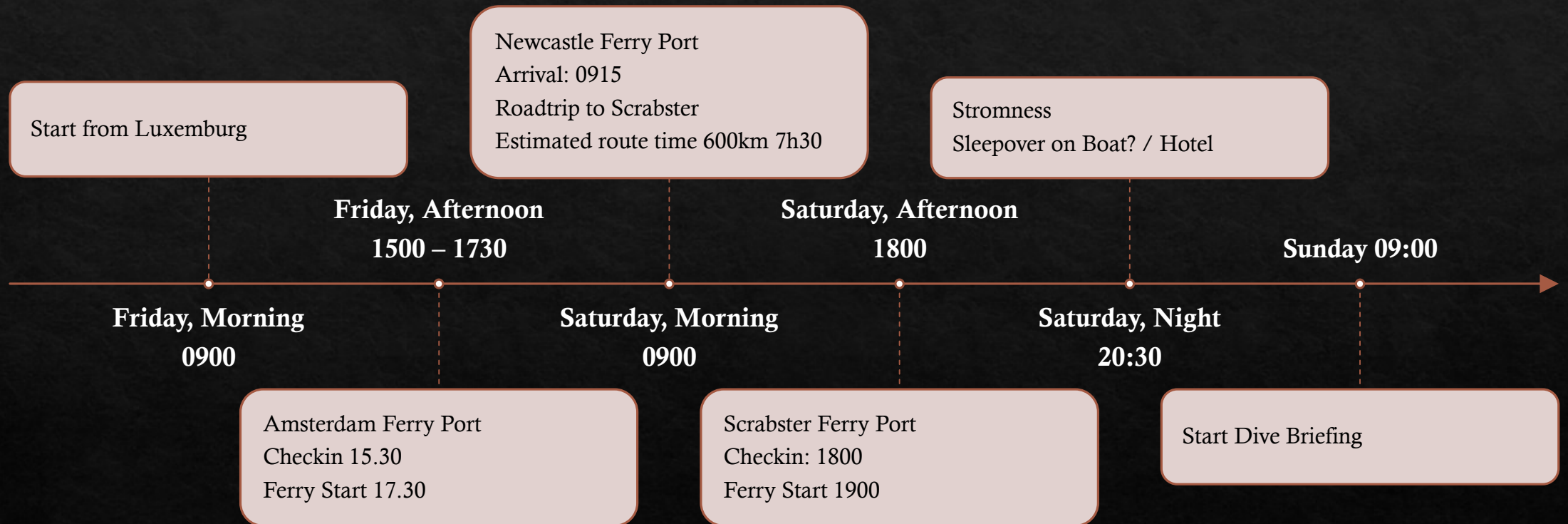

Roadtrip from Luxembourg to Stromness alternative Plan

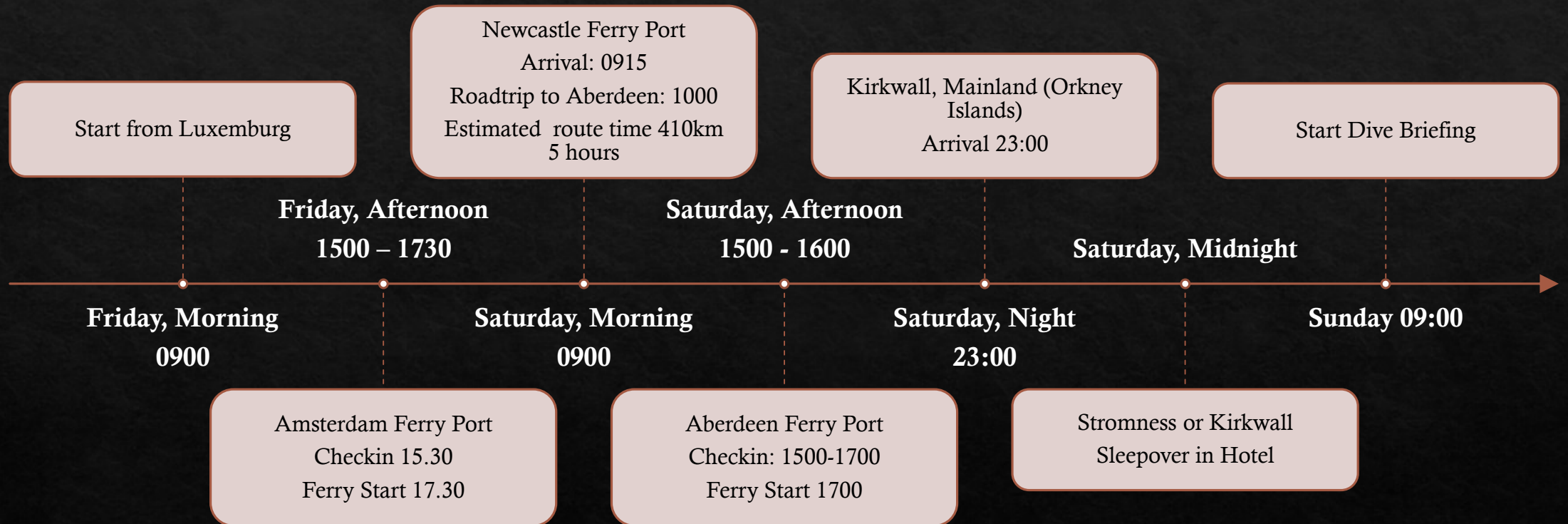

Diving the shipwrecks of scape Flow

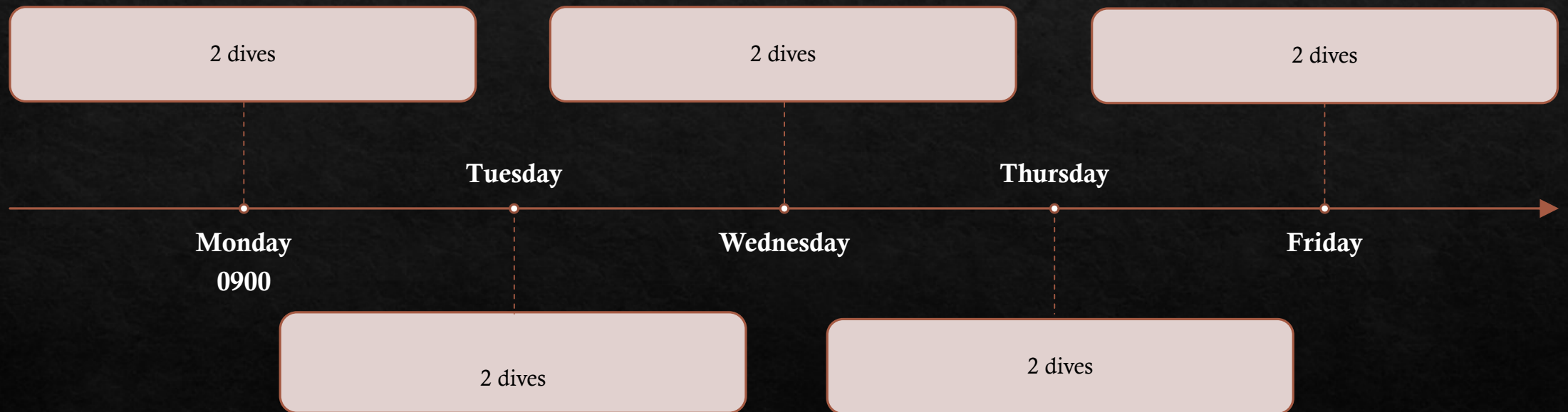

Roadtrip from Stromness to Luxembourg



Total Price:
Fullcharter 11650 Pounds (12 persons)

Diving liveaboard + breakfast:
1140 Euro
(deposit 490€ now & 650€ april 2025)

Transport: 500€ (estimation)
+/- 1600 €

not included
Gases, softnolime, dinner, lunch, drinks

(prices reevaluated by end 2024)

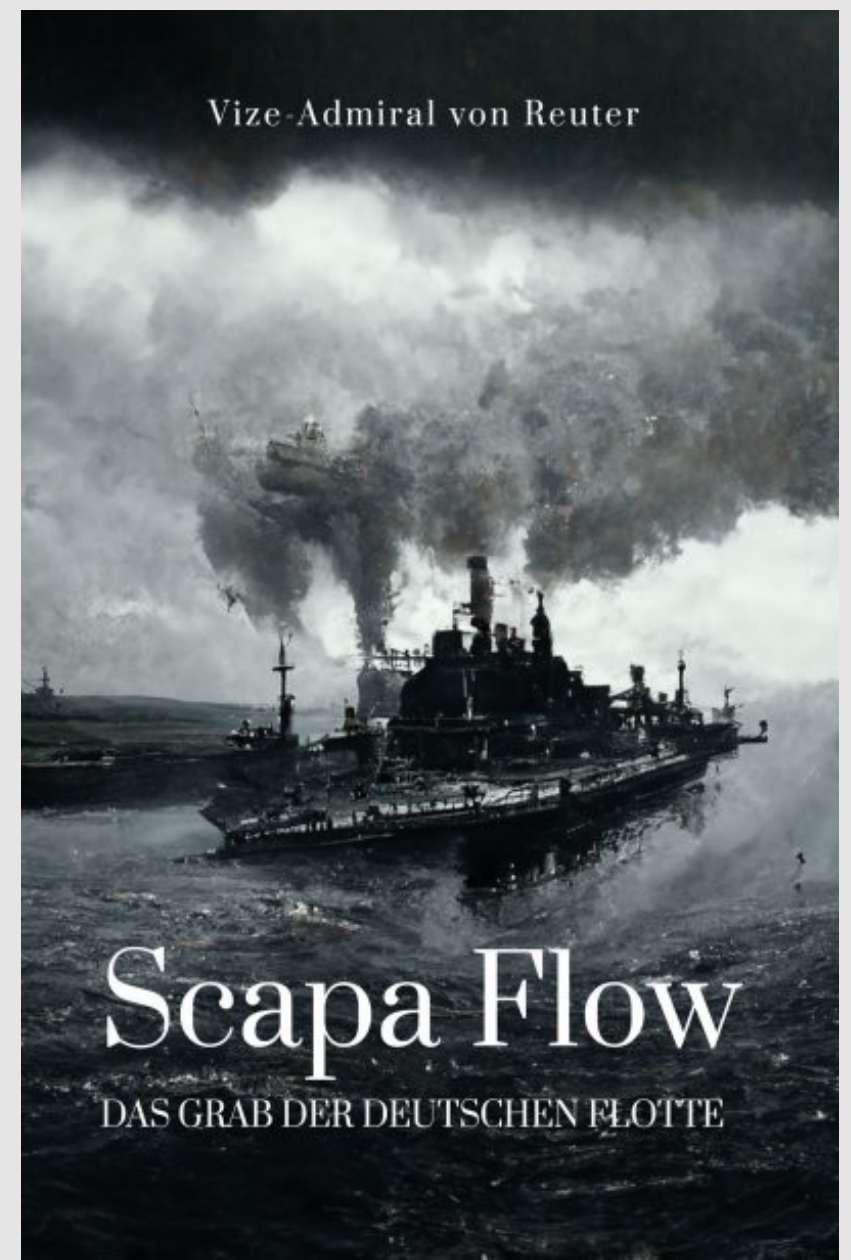



Merci